

—
—
—
—

(
)
)



↕
↕

20 21
40 60 c



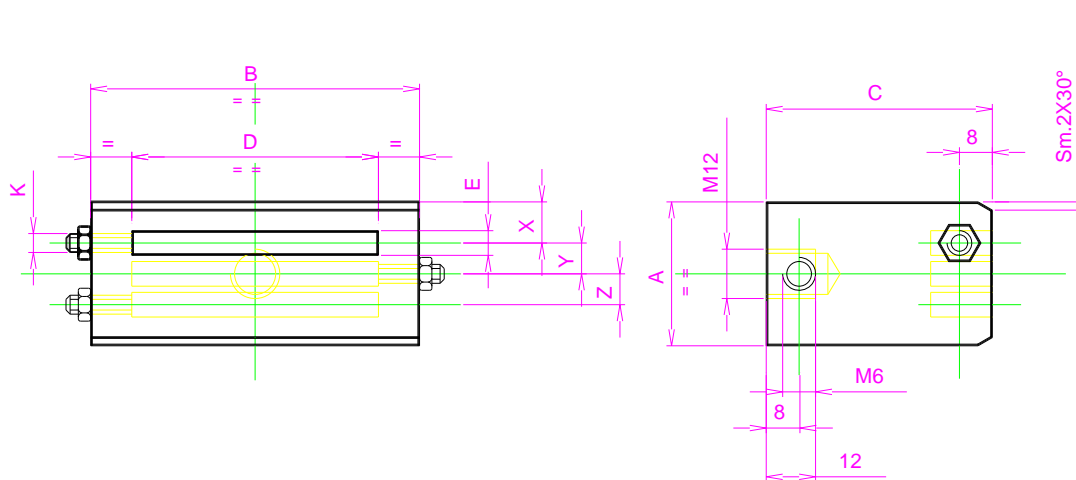

-	A	B	C	D	E	X	Y	Z	K		1					
											10-15/10	20/10	25/10	30/10	40/10	50/10
PC	2/4	20	25	40	14	4	10	---	---	M4	1	9	7	---	---	---
	2/4S	20	35	40	20	4	10	---	---	M4	1	13	10	---	---	---
	3/4	20	50	40	30	4	10	---	---	M4	1	20	15	---	---	---
	4/4	20	70	40	50	4	10	---	---	M4	1	33	25	---	---	---
	5/4	20	100	40	80	4	10	---	---	M4	1	53	40	---	---	---
PC	6/4	20	50	45	30	4	7.25	5.5	---	M4	2	20	15	---	---	---
	7/4	20	70	45	50	4	7.25	5.5	---	M4	2	33	25	---	---	---
PC	8/4	30	50	50	30	4	9.5	5.5	5.5	M4	3	20	15	---	---	---
	9/4	30	60	50	40	4	9.5	5.5	5.5	M4	3	26	20	---	---	---
	9/4S	30	70	50	50	4	9.5	5.5	5.5	M4	3	33	25	---	---	---
PC	11/6	20	35	40	20	6	10	---	---	M6	1	---	---	8	6	---
	13/6	20	55	40	40	6	10	---	---	M6	1	---	---	16	13	---
	14/6	20	80	40	60	6	10	---	---	M6	1	---	---	24	20	---
	28/6	20	100	40	80	6	10	---	---	M6	1	---	---	32	26	---
PC	15/6	30	55	50	40	6	11.25	7.5	---	M6	2	---	---	16	13	---
	15/6S	30	100	50	80	6	11.25	7.5	---	M6	2	---	---	32	26	---
PC	16/6	35	60	50	40	6	10	7.5	7.5	M6	3	---	---	16	13	---
	29/6	35	70	55	50	6	10	7.5	7.5	M6	3	---	---	20	16	---
	17/6	35	80	55	60	6	10	7.5	7.5	M6	3	---	---	24	20	---
	18/6	35	100	50	80	6	10	7.5	7.5	M6	3	---	---	32	26	---
PC	20/8	20	36	40	20	8	10	---	---	M6	1	---	---	---	5	4
	21/8	20	60	40	40	8	10	---	---	M6	1	---	---	---	10	8
	22/8	20	80	40	60	8	10	---	---	M6	1	---	---	---	15	12
	23/8	20	100	40	80	8	10	---	---	M6	1	---	---	---	20	16
	30/8	30	60	50	40	8	10.25	9.5	---	M6	2	---	---	---	10	8
PC	24/8	30	80	50	60	8	10.25	9.5	---	M6	2	---	---	---	15	12
	25/8	30	100	50	80	8	10.25	9.5	---	M6	2	---	---	---	20	16
PC	31/8	40	60	58	40	8	10.5	9.5	9.5	M6	3	---	---	---	10	8
	26/8	40	70	58	50	8	10.5	9.5	9.5	M6	3	---	---	---	12	10
	27/8	40	100	60	80	8	10.5	9.5	9.5	M6	3	---	---	---	20	16

-
-
-
-

RPC 101

⇒

⇒

⇒

SR100,

